

N.A. Woodworth

An ITW Workholding Company

Stationary Workholding Solutions

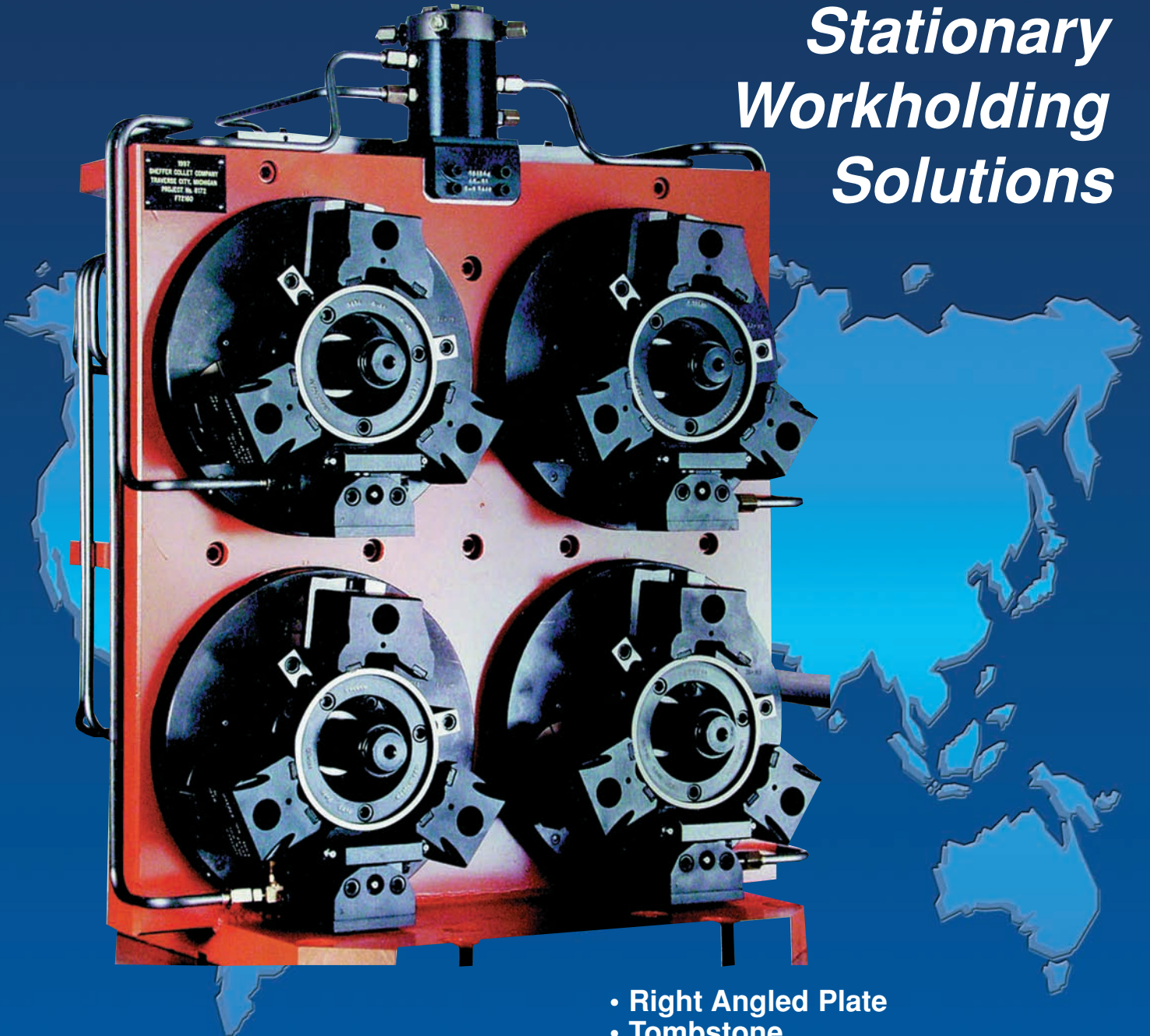

- Right Angled Plate
- Tombstone
- Self-Contained
- Quick Change Mounting System
- Vertical and Horizontal Applications
- Modular Construction Design
- Hydraulic, Pneumatic and Manual

WORKHOLDING SOLUTIONS WORLDWIDE

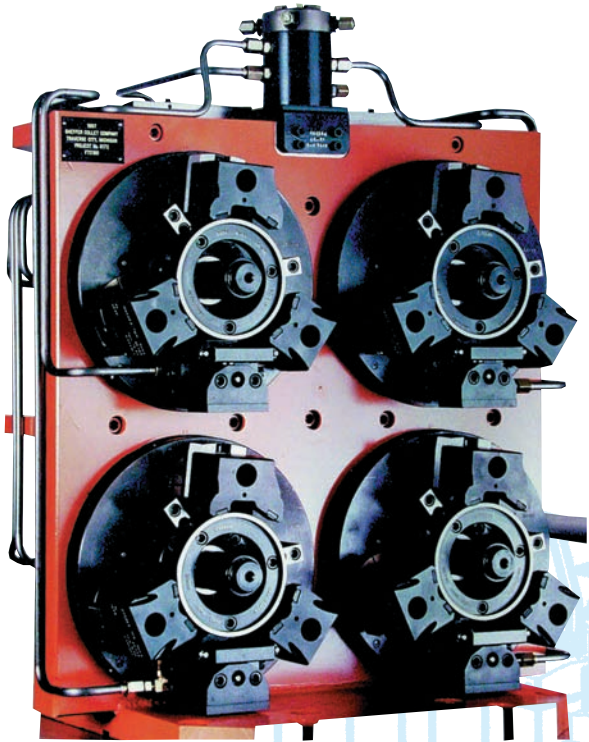

Right Angle Fixture Plates

- Hydraulic or Pneumatic
- Clamp with Pressure or Springs
- Pressure Maintained with Accumulator
- Round or Prismatic parts
- For Horizontal Machining Centers
- Modular Component Designs
- Traditional Workholding Designs

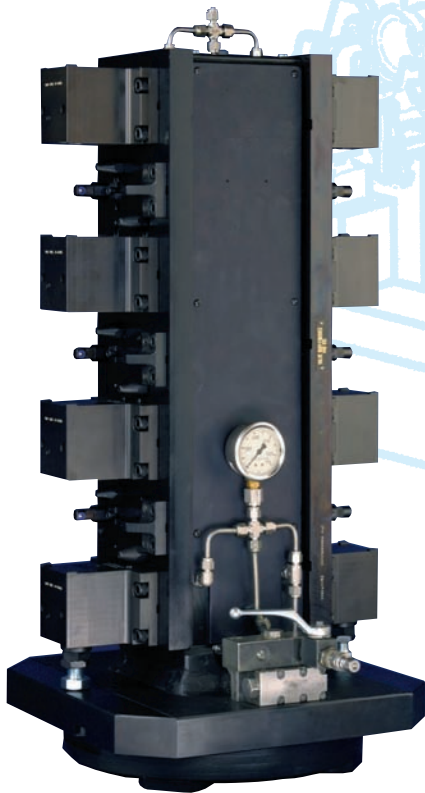
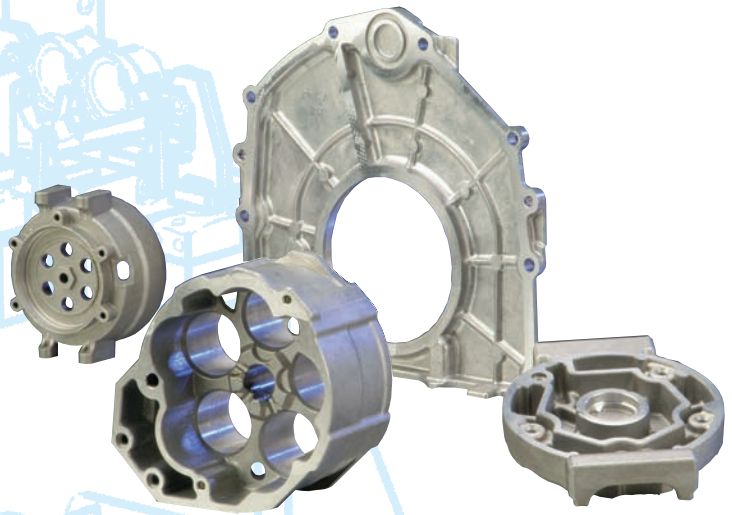

Tombstone Fixtures

- Hydraulic — 3000 to 5000 PSI
- Pressure Maintained with Accumulator
- 2, 4 or 6 Sided Tombstones Available
- Modular Component Designs
- For Horizontal Machining Centers



Stationary — Self Contained Fixtures

- Hydraulic or Pneumatic
- Clamp with Pressure or Springs
- For Vertical Machining Centers
- For Rotary Dial, Multiple Station Machines
- For 5-Axis Rotary Tables
- Traditional Workholding Designs



Manual — Tork-Lok Fixture

- Three Base Models Available
- Gripping Range from .500" to 2.843" in Diameter
- Versatile I.D. Clamping

Tru-Change Coupling Rings

- 5 Micron Repeatability
- High Torsional Load Capacity
- Patented Curved Tooth Design
- Self Centering and Zero Backlash
- Quick Change Mounting System
- Adaptable to any Fixture or Workholding Device



At ITW Workholding, our engineering and manufacturing capability allow us to tackle round and prismatic fixturing with simplicity and accuracy. Whether your application requires tombstone, face-plates, hydraulic or pneumatic actuation, our experts can deliver a complete package on time and affordably. And when it's time for debugging your process, you will find ITW Workholding an active participant in resolving open issues.

ITW Workholding Group



FORKARDT
AN ITW WORKHOLDING COMPANY



Buck Chuck
An ITW Workholding Company

L O C A T I O N S W O R L D W I D E

FORKARDT DEUTSCHLAND GMBH
Heinrich-Hertz-Str. 7
D-40699 Erkrath
Tel: (+49) 211-25 06-0
Fax: (+49) 211-25 06-221
E-Mail: info@forkardt.com

FORKARDT SCHWEIZ AG
Industriestrasse 3
CH-8307 Effretikon
Tel: (+41) 52-3 5531 31
Fax: (+41) 52-3 4352 40
E-Mail: info-ch@forkardt.com

FORKARDT FRANCE S.A.R.L.
28 Avenue de Bobigny
F-93135 Noisy le Sec Cédex
Tel: (+33) 1-41 83 12 40
Fax: (+33) 1-48 40 47 59
E-Mail: forkardt.france@forkardt.com

BUCK CHUCK
2155 Traversefield Drive
Traverse City, MI 49686, USA
Tel: (+1) 231-995-8312
Fax: (+1) 231-947-4953
E-Mail: buck.forkardt@forkardt.com

N.A. WOODWORTH
2002 Stephenson Hwy.
Troy, MI 48083, USA
Toll Free: 800.544.3823
E-Mail: sales@itworkholding.com
Website: www.itworkholding.com

www.forkardt.com

www.itworkholding.com